

GREAT PARK NEIGHBORHOODS





Park-front living in Irvine

Great Park Neighborhoods is a community of parks surrounded by homes (not the other way around). And not simply greenspaces, but places to walk, run, ride, swim, play, climb, explore, meet your neighbors, or simply relax under a big shady tree. All threaded together with a comprehensive network of trails that connect you to your neighbors and, of course, to more parks—including the Orange County Great Park. And those park-surrounded homes? They're some of the freshest, smartest new homes Irvine has ever seen, available in a variety of sizes and styles, located in the top-ranked Irvine Unified School District.

GreatParkNeighborhoods.com | 949.304.6075



▲ BEACON PARK



BEACON PARK ▲



THE POOLS ▲

▼ PARASOL PARK



▲ PAVILION PARK

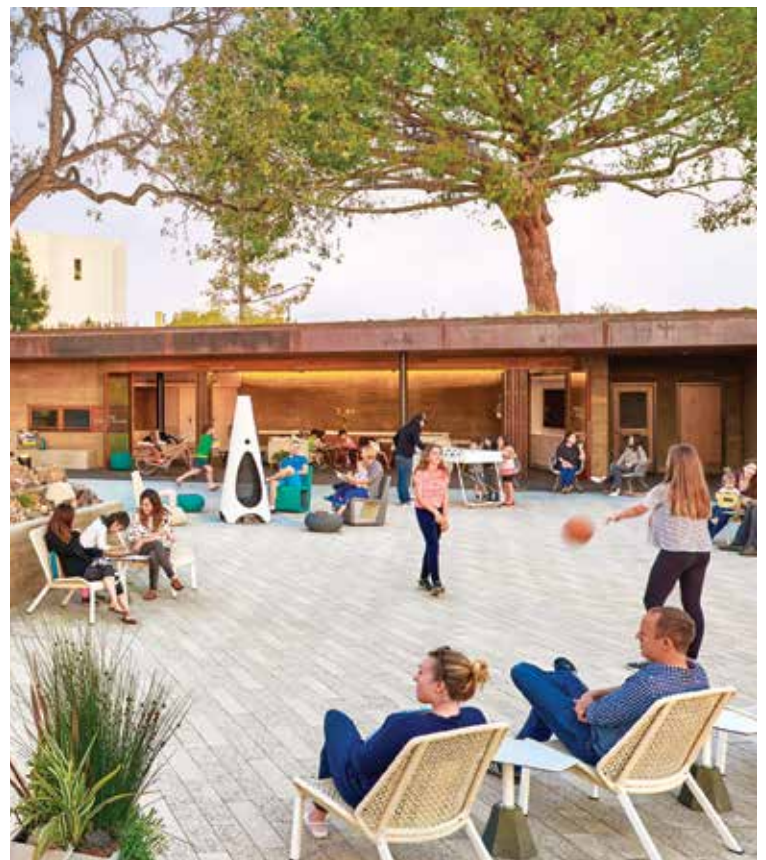



CADENCE PARK ▲



▲ NOVEL PARK

A park-front perspective

The world's great neighborhoods have one thing in common. A defining park that adds a sense of purpose to stepping out your door. As the name implies, parks are in the Great Park Neighborhoods' DNA. Not as an afterthought but as the foundation for what helps a neighborhood—and the people who live in it—thrive. Evident in neighbors gathering for live music or a seasonal celebration. Kids riding bikes instead of a bus to school. The shimmer of a cool swimming pool in the warm California sunshine. These are places that give people energy in a world that requires more of it. And you'll find them here.

New homes in Irvine from the \$500,000s to over \$1,000,000.

GreatParkNeighborhoods.com | 949.304.6075

FIVEPOINT.

Great Park
NEIGHBORHOODS 